

EX Torch

ZONE
21/22

Ex tb IIIC T85°C Db IP65
MASC S/20-2181X

EX

IP
65

Who says tough can't be pretty?

Our industrial LED bulkhead is composed of high-pressure LM6 Marine grade cast aluminum body and clear polycarbonate cover all wrapped up with an IP65 rating and able to withstand temperatures of 40°C ambient. Available in 4 different light distributions and standard with a replaceable 10kV surge protection this luminaire is rated for zone 21 and zone 22.



Proudly manufactured in
South Africa using
European LED Technology



kV Protection:
Up to 10kV
Standard



**Outdoor/
Indoor**



**LM6 Marine
Grade Cast
Aluminum**



**5 Year
Warranty**

energywise

Better light
through research.

INTRODUCING



Marine grade high-pressure die cast aluminum body and clear polycarbonate cover wrapped up with an IP65 rating.

Our EX TORCH range is based off of the same chassis of our industrial Torch Bulkhead. What this means for you is a fitting whose body has proved itself at cooling, protecting and housing luminaries in some of the most rugged environments in Africa.

We then combined this chassis with EX technology sourced from the leading component manufacturers in both Europe. These new systems were then put through months of testing to ensure that the final product could deliver against our exacting specifications.

The final result, an EX light at the leading edge of technological advancements in LED EX lighting technology.

KEY FEATURES

LENSES

- 4 different optics.

FRONT COVER

- Impact rating IK08/5J

TEMPERATURE

- Ambient room temperature -25°C to +40°C.

MOUNTING OPTIONS

- Surface mounting brackets
- Pole mounting brackets
- Swivel mounting bracket
- Adapter 44 mounting bracket



*25°C is for Textbooks, Not Africa's Sun:
All EW Lights are designed for the 30°C Reality. Minimum.

Specifications

The perfect configuration for its job.



kV Protection:
up to 4kV, 10kV
on request



Indoor/Outdoor



Impact Resistance:
IK08/5J



Lenses:
Polycarbonate



Construction:
Aluminum &
Stainless Steel



Marine Grade Aluminum



L&B Life Rating
L80 B10
60 000 hrs

EX TORCH

Raw Lumen:
Effective Lumen:

10,560 lm
8584 lm

Wattage:
Power Factor:
Raw Efficacy:
Effective Efficacy:

67W
0.95
160 lm/w
130 lm/w

Max Ta:
L&B:
Hrs:

40°C
L80 B10
60 000 Hrs

Fitting Size LxBxH: **450mm x 280mm x 115mm**

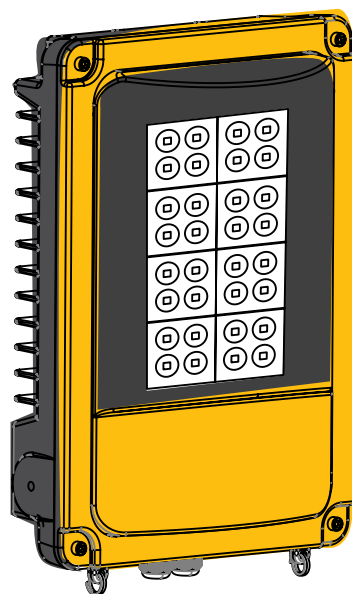

Installation

Easy to install, **Saving** you time & money

The EX Torch is a purpose designed LED bulkhead built for an industrial environment where dust is a potential hazard. Four easily attached mounting feet as standard. Alternatively pole brackets or extender 44 bracket or swivel bracket is optional.

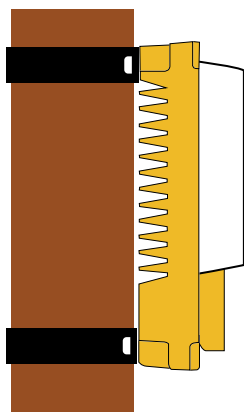

Option 1 Pole Brackets

Ideal for pole mounting.

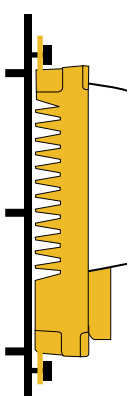

Option 2 Adapter 44 Bracket

Seamless integration.

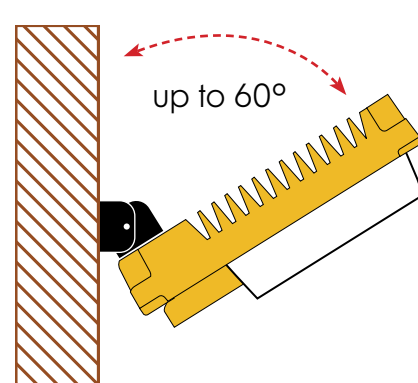

Option 3 Swivel Bracket

Seamless angle adjustments.

Disclaimer:

While every effort is made to ensure the accuracy of technical details at the time of publication, we reserve the right to modify or upgrade any product or component specifications without prior notice. Our products undergo continuous improvements in technology, energy efficiency, safety, and cost-effectiveness to meet evolving industry standards and supplier updates.

All upgrades are made to enhance product quality, and as such, no claims or complaints will be entertained regarding specification changes.

We are ISO 9001:2015 compliant, and our assembly line adheres to IEC 60958 guidelines. Our products are covered by a Product Liability Policy, and our LED products come with a 5-year warranty (T&Cs apply—please contact Head Office for details).



Distribution Options

The light you need,
where you want it.

Our LED bulkhead offers a range of optical lenses designed to direct light precisely where it's needed, optimizing both efficiency and visibility. Each lens provides a unique distribution pattern tailored for different applications.

Available Beam Options:

P2M: A controlled beam designed for targeted illumination, reducing light spill and enhancing efficiency in areas requiring direct lighting.

M5: A medium-wide distribution offering balanced coverage, ideal for pathways, corridors, and general-purpose lighting.

A5: A broader asymmetrical beam for illuminating large open spaces such as parking areas or pedestrian walkways.

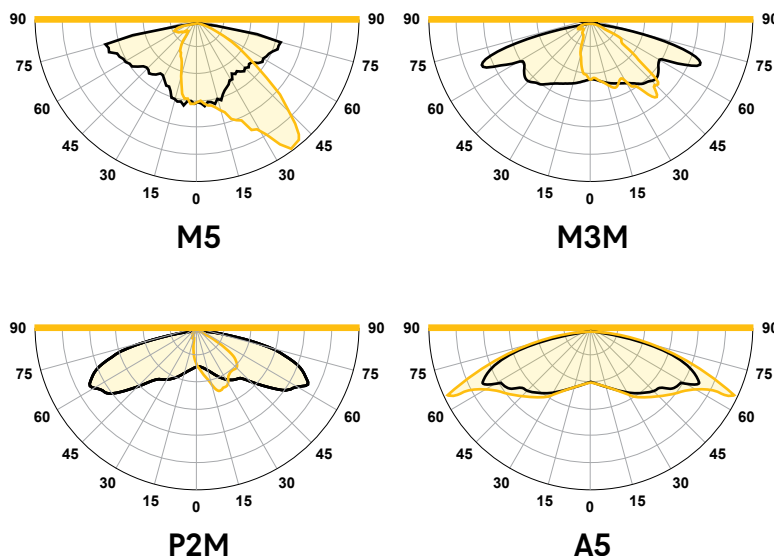

A Closer Look

Engineered to the
highest standards.

Heat-sink

This industrial bulkhead is specifically designed for LEDs, it has an external heat sink allowing for effective heat dissipation outside of the fitting.

Cover

Polycarbonate cover offers great IK08 impact protection. The continuous rubber gasket allows for a water-resistant (IP65) assembly.

Lenses

For your choice of distribution options.

LEDs

Sourced from the best component manufacturers in Europe to ensure maximum lifespan, quality and light spectrums.

Finishings

All fasteners are Stainless Steel 316 rust free longevity.

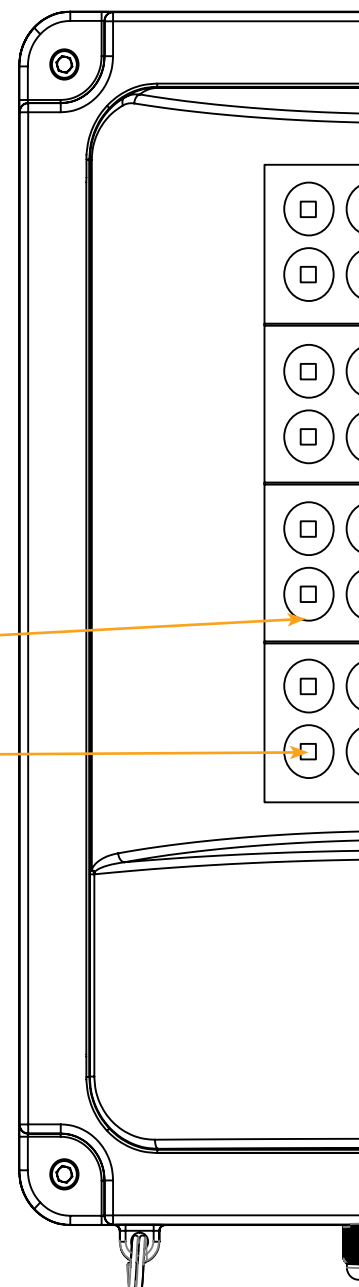
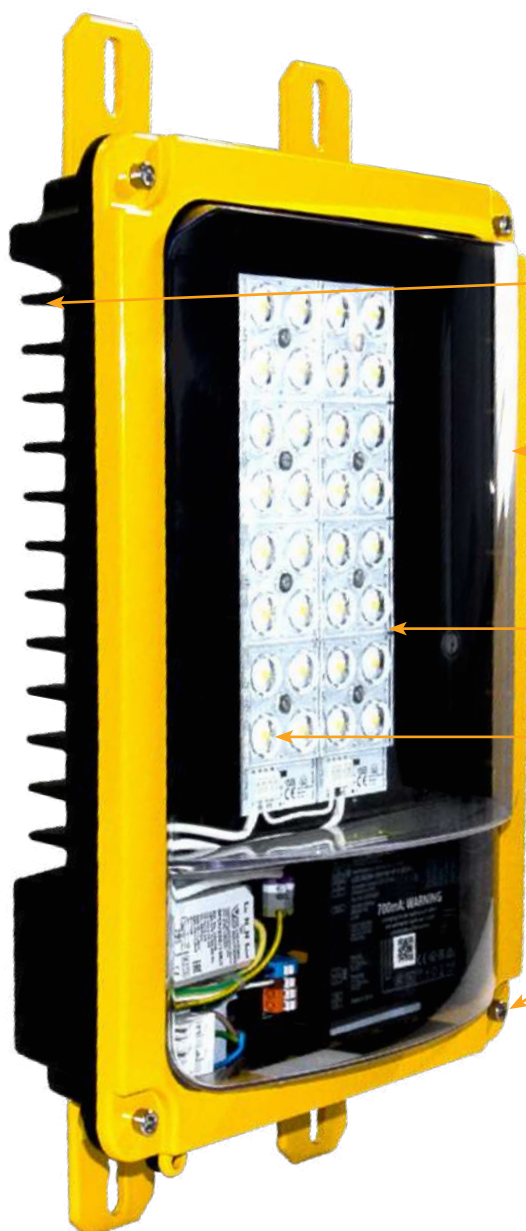

Features

Standard across the EX Torch range.



Water resistant.



Recyclable aluminum.



Polycarbonate lens and front cover.



Serviceable: All units are serviceable and all parts replaceable.



5000K Standard, 4000K, 6500K on request.



Colour rendition index 75+, 80+ on request



Top Bin Chips <3 MacAdams



Earth connection and CLASS I insulation fixture.



Front cover impact rating IK08/5J.



Replacable voltage surge protection 10kV.



Aluminum alloy with stainless steel 316 fasteners.



Surface mount.



LM6 Marine Grade Cast Aluminum



L&B Life Rating: L80 B10, 60 000 hrs

Extras

Optional extras



IES files available.



VOLTpro

Effective Lumen Output After Warm-up

We adhere to industry best practices in providing accurate Effective Performance Data (Lumens, Watts, and L&B) that account for driver and LED thermal losses during the warm-up period.

To ensure precise measurements, we conduct Energy and Photometric Testing only after the LED within the fitting has been powered on long enough to reach a stable and constant lumen output—achieving thermal equilibrium at an ambient temperature (T_a) of 35°C.

Unfortunately, some suppliers misrepresent efficacy by inflating lumen values 10–20% above the true effective output. This is often done by using raw LED photometric data, which:

- Excludes driver losses (typically 2–5%)
- Ignores thermal adjustment losses, which can take 20–240 minutes and account for 7–15% reduction in output

Given these factors, the actual Effective Lumen Output is often lower than raw values suggest. In extreme cases, some suppliers report only raw LED values, completely disregarding real-world performance.

For transparency and accuracy, we ensure our data reflects true effective lumens, providing reliable performance metrics you can trust

5 year warranty:

Please visit
www.energywise.co.za



Designed and
Manufactured by

energywise

**Better Light
Through Research.**

sales@energywise.co.za | www.energywise.co.za

T: +27 31 764 2345 / +27 87 941 0012

Physical address: Unit 5 Edstan Business Park, 2 Ibhubesi Road, Riverhorse Valley, Durban, South Africa, 4017

Postal address: PO Box 1166, Kloof, South Africa, 3640



Permit number
MASC-098MR



Torch: Adapter 44

Applicable to Torch and EX Torch

Simplify installation with the "adapter 44" mounting bracket, specially designed for seamless integration with pre-existing old "44 style" mounting bolts. Makes upgrading to the Torch bulkhead faster, easier, and hassle-free.

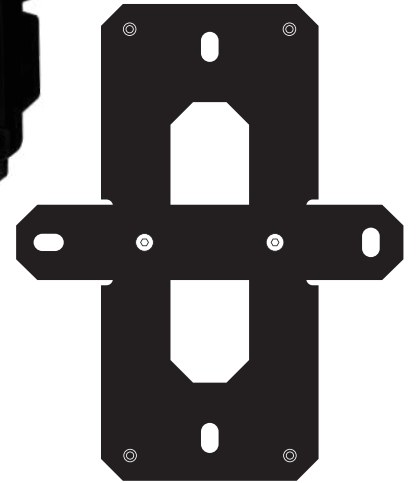

Instructions

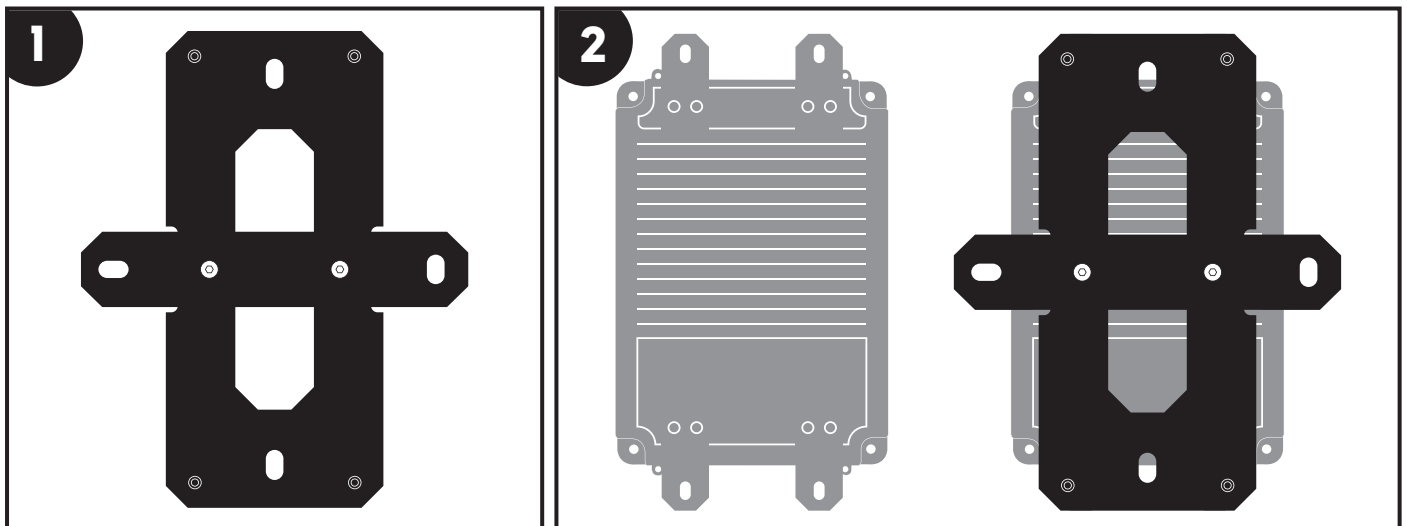

Step 1: Mount the "adapter 44" using the four pre-existing bolts on site. **Step 2:** Back view before & after the "adapter 44".

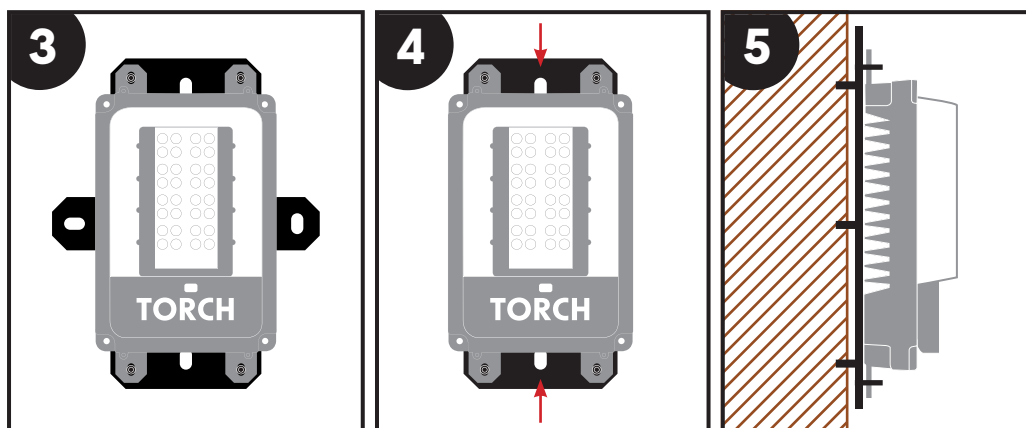

4 holes mounting option

2 holes mounting option

Step 3: Front view of the Torch bulkhead mounted onto "adapter 44" using a 4 hole mounting option.

Step 4: For width constraints, the middle bracket can be removed for a two hole mounting option.

Step 5: Side view of the Torch bulkhead mounted using the "adapter 44".

WALL MOUNTING FASTENERS NOT PROVIDED.

Torch: Pole Brackets

Applicable to Torch and EX Torch

Torch pole Brackets, for pole mounting. These brackets ensure a secure and stable fit, making them ideal for outdoor lighting applications such as streetlights, pathways, and perimeter illumination.

Secure Pole Fit: Designed for firm and reliable attachment.

Durable Build: Built to withstand tough outdoor conditions.

Easy Installation: Simple setup for quick deployment.

**AVAILABLE FOR DIFFERENT POLE
DIAMETER ON REQUEST.**

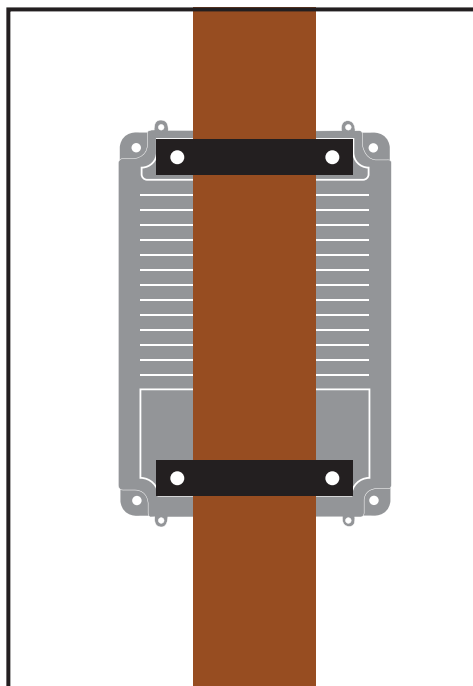
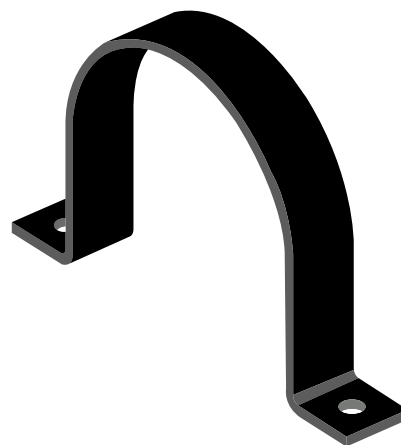

Back View

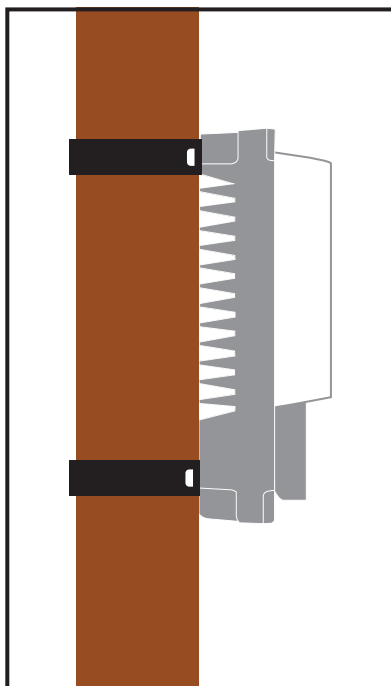

Side View

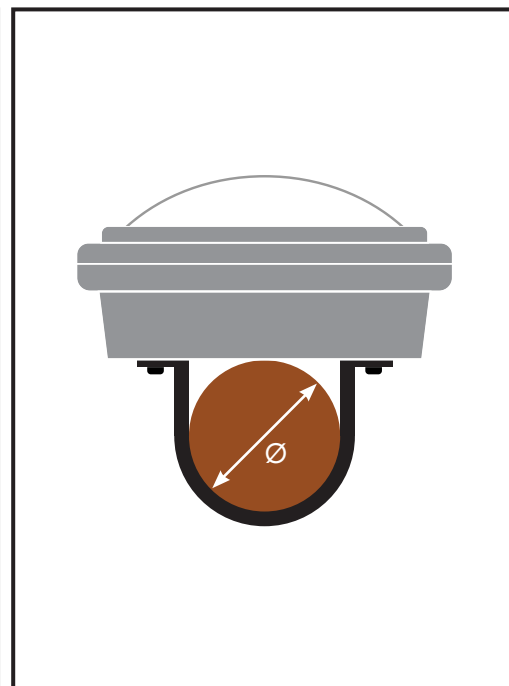

Top View

POLE MOUNTING FASTENERS NOT PROVIDED.

Torch: Swivel Bracket

Applicable to Torch and EX Torch

Our industrial LED bulkhead now features a new mounting option: the swivel bracket. Designed for angle adjustments, ensuring optimal light placement in any environment. The bracket comes sub assembled ready to be mounted on to the luminaire.

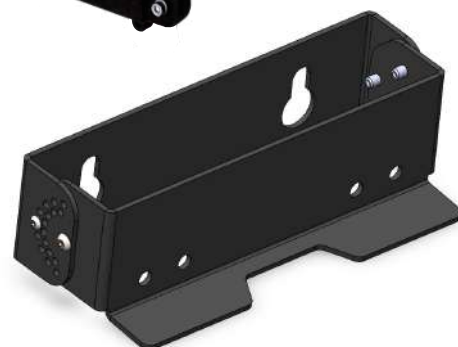

Instructions

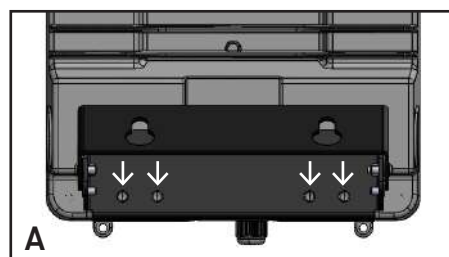

Step 1: Use the provided M8 x 16 (x4) screws to mount the swivel bracket to the bulkhead Torch (see reference A).

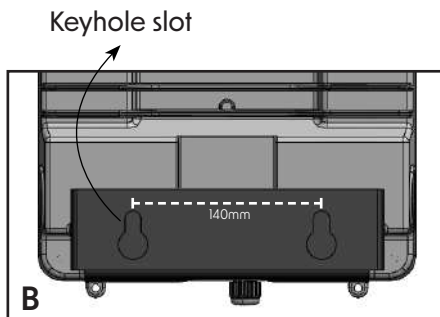

Step 2: The bracket features two keyhole slots with a 140mm pitch (see reference B), compatible with mounting fasteners with heads no larger than 22mm (see reference C).

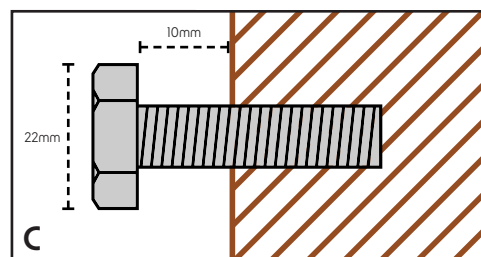

Step 3: Install the fastener into the wall leaving $\pm 10\text{mm}$ gap (see reference C) for the easy installation of bracket through the keyhole slots.

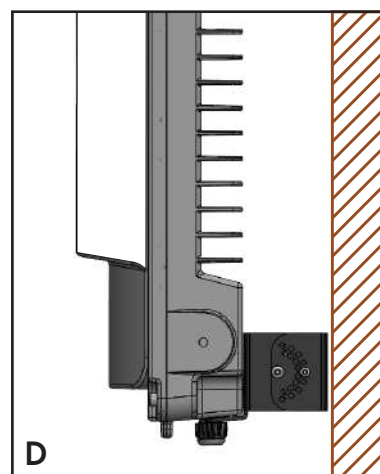

Step 4: Hang the Torch bulkhead into the fastener and tighten securely.

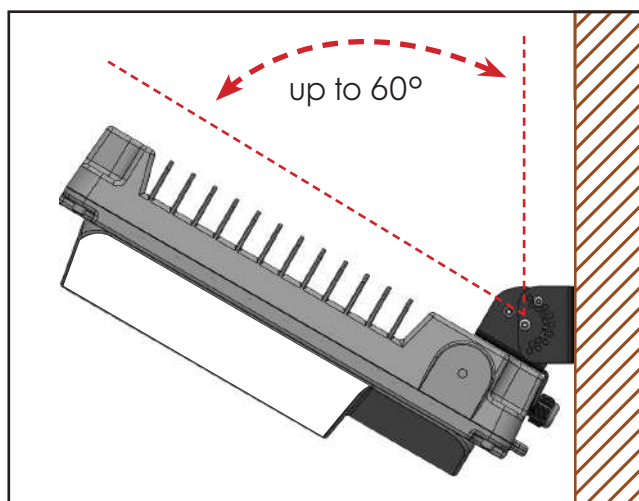
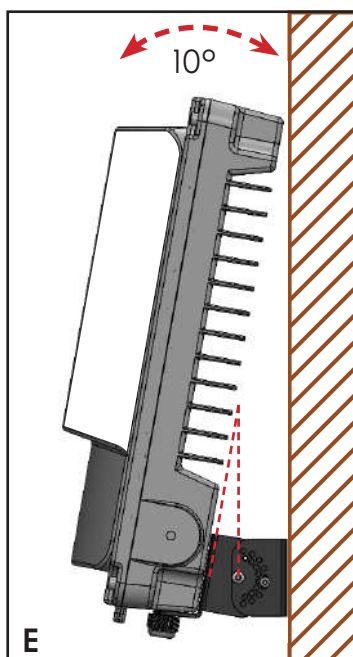

Step 5: Once the Torch bulkhead is mounted securely on the surface, use the provided M4 x 12 screws (x2) to adjust the angle from -10° to $+60^\circ$.

WALL MOUNTING FASTENERS NOT PROVIDED.

Energywise lighting options

Energywise specialises in LED luminaries for industrial, EX, commercial and horticultural applications.

INDUSTRIAL

						
Bay XP Factories, Warehouses, Cold rooms etc.	Bay XL Factories, Warehouses, Supply rooms etc.	Bay XE Factories, Warehouses, Supply rooms etc.	DUSTPROOF Warehouses, Car parks, Corridors.	VANDAL-RESISTANT DUSTPROOF Car parks, Corridors, Mills.	PUREBox Panel Medical & laboratory, Clean rooms etc.	Torch Bulkhead Heavy industrial areas.
Standard Height: 6-25m IP: 65 Temp: 40/65°C	Standard Height: 3-20m IP: 40 Temp: 30°C	Standard Height: 6-25m IP: 20 Temp: 30°C	Standard Height: 2.5-8m IP: 66 Temp: 35°C	Standard Height: 2.5-8m IP: 66 Temp: 35°C	Standard Height: 3-5m IP: 54 Temp: 35°C	Standard Height: 6-25m IP: 65 Temp: 30°C





						
Pod IP65 Tamperproof and nearly unbreakable.	Bay XF Get the job done, Glare-Free.	Plate XP Swiss army knife of lighting.	TOBLO bay Factories, Warehouses, Supply rooms etc.	Bay XT Distribution centers, Warehouses etc.	Retrofit 44 Converting old HID tech to LED	Retrofit 22 Converting old HID bulkhead to LED
Standard Height: 2-5m IP: 65 Temp: 35°C	Standard Height: 2-10m IP: 20 Temp: 30°C	Standard Height: 6-25m IP: 65 Temp: 35°C	Standard Height: 6-25m IP: 40 Temp: 40/30°C	Standard Height: 3-20m IP: 40 Temp: 35°C	Standard IP: 00 Temp: 30°C	Standard IP: 00 Temp: 35°C

RETAIL & COMMERCIAL

						
LEDrail 1000 Shops, Production facilities, parking	LEDrail 2000 Shops, Sheds, Underground parking	LEDrail 4000 Retail, board rooms, department stores.	LEDrail 8000 Retail, board rooms, department stores.	LEDrail 4-100 All retail outlets, showrooms, offices etc	LEDrail 4LCO Shops, Production facilities, showrooms etc	Linear 4-300 Glare free precision lighting
Standard Height: 2.5-10m IP: 40 Temp: 30°C	Standard Height: 2.5-10m IP: 40 Temp: 30°C	Standard Height: 2.5-6m IP: 40 Temp: 35°C	Standard Height: 2.5-6m IP: 40 Temp: 35°C	Standard Height: 2.5-10m IP: 40 Temp: 35°C	Standard Height: 2.5-10m IP: 40 Temp: 35°C	Standard Height: 2.5-10m IP: 40 Temp: 35°C

						
Downlighter Offices, retail and hospitality settings.	Panel 595x595 Offices, healthcare, educational facilities.	Panel 1195x595 Offices, commercial, educational settings.	EX Bay XP Factories, Warehouses, Mills, Marine etc.	EX DUSTPROOF PREMIUM Warehouses, Car parks, Mills.	EX DUSTPROOF Warehouses, Car parks, Corridors, Mills.	EX Pod Factories, Mines, Marine etc.
Standard IP: 40 Temp: 30°C	Standard IP: 40 Temp: 30°C	Standard IP: 40 Temp: 30°C	Standard Height: 6-25m IP: 65 Temp: 40°C	Standard Height: 2.5-8m IP: 65 Temp: 35°C	Standard Height: 2.5-8m IP: 65 Temp: 35°C	Standard Height: 2-5m IP: 68 Temp: 40°C

EARTH

			
EX Torch Heavy industrial areas.	EARTHbay Horticulture, Open areas etc	EARTHplate Horticulture, Rack/ Under shelf etc	EARTHpod Horticulture, Propagation, Racks etc.
Standard IP: 65 Temp: 40°C	Standard From canopy: 0.5-2m IP: 65 Temp: 35°C	Standard From canopy: 0.4-2m IP: 65 Temp: 35°C	Standard From canopy: 0.2-1m IP: 65 Temp: 35°C

Lights on. Job done.

energywise

Better light
through research.