

Vandal-Resistant Dustproof



Industrial

IP
66

Water, vapour, vandal & dust proof.

Our IP66 LED dustproof is composed of a UV stabilized polycarbonate body which gives excellent protection from long-term degradation from sunlight as well as an IK08/5J diffuser impact rating.



Proudly manufactured in
South Africa using
European LED Technology



kV Protection:
Up to 4kV, 10kV
on request



Indoor



SABS
Approved



5 Year
Warranty

energywise

Better light
through research.

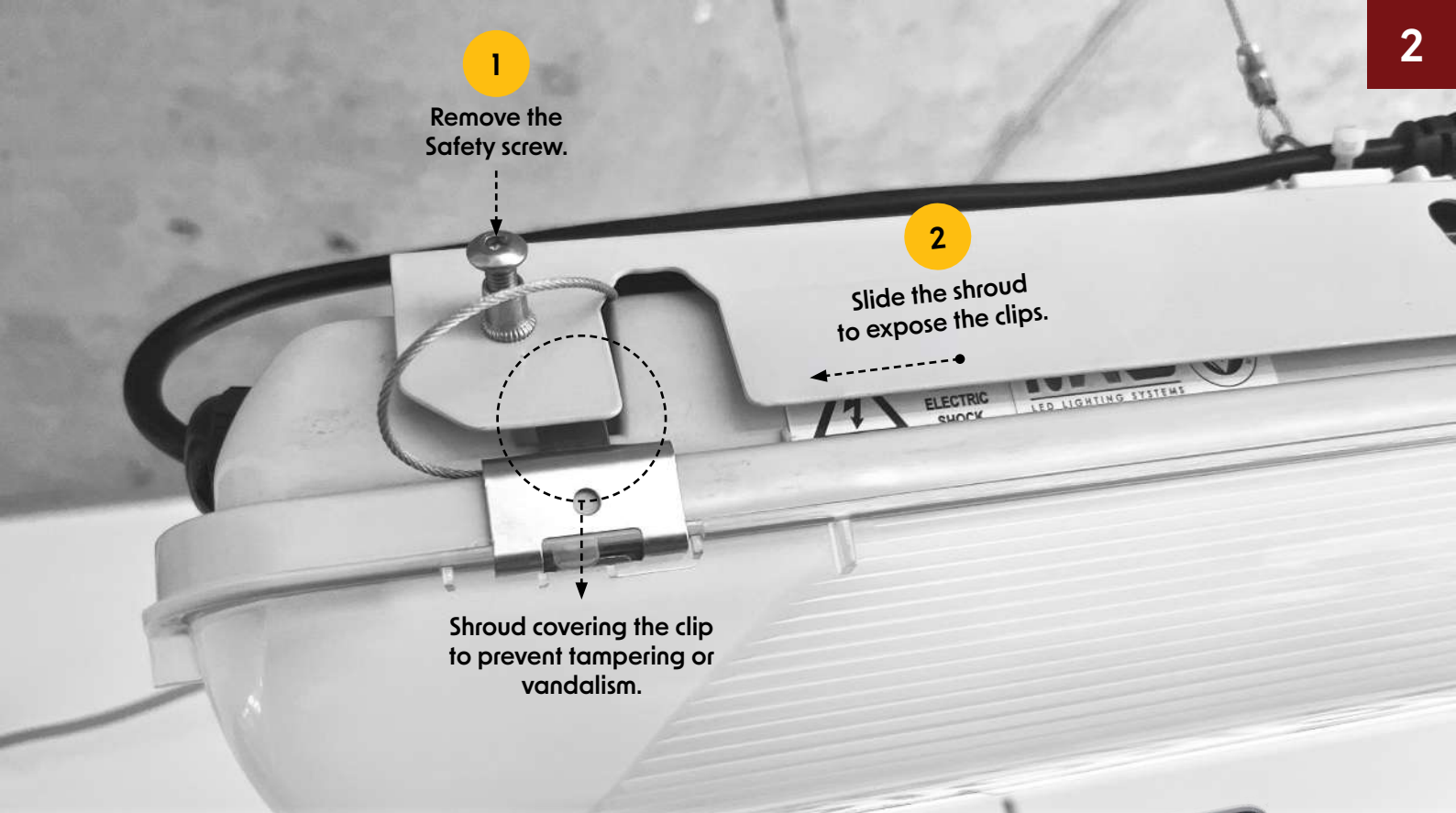

1
Remove the
Safety screw.

2
Slide the shroud
to expose the clips.

Shroud covering the clip
to prevent tampering or
vandalism.

An Extra Layer of Protection.

Our SABS-approved dustproof luminaire isn't just another light—it's a vandal-resistant powerhouse. Featuring specialized anti-vandal shroud, it's designed to withstand interference while maintaining easy serviceability. Built with a premium body imported from Spain and top-tier components from Germany and Italy, each unit is assembled, designed, and produced in South Africa, ensuring world-class quality with local expertise.

Installation is fast, maintenance is minimal, and performance is unmatched. With exceptional human-centric light quality, this luminaire is as effective as it is resilient.

Dustproof fittings have been around for decades, but we've taken that tried-and-tested form factor and made it better. Thanks to cutting-edge LED technology, it now outperforms outdated fluorescents in durability, efficiency, light quality, and—most importantly—energy savings. This is the next generation of dustproof lighting—tough, efficient, and built for real-world conditions. outstrips old Fluorescents with longevity, efficiency, light quality and perhaps most importantly, electrical costs.

KEY FEATURES

3 SIZE OPTIONS

- Dustproof 2 Foot
- Dustproof 4 Foot
- Dustproof 5 Foot

DIFFUSER

- Impact rating IK08/5J

TEMPERATURE

- Ambient room temperature -25°C to $\leq 35^{\circ}\text{C}$.



Optional:
Bluetooth, Wifi,
Dali & Bi Level.
Casambi App
featured above.



*25°C is for Textbooks, Not Africa's Sun:
All EW Lights are designed for the 30°C Reality. Minimum.

Dustproof Vandal-Resistant Specifications

Spec'ed for every situation.



kV Protection:
Up to 4kV, 10kV
on request



5000K standard
3000K, 4000K,
6500K available
CR>80 R9>13



Indoor/Outdoor



Impact Resistance:
IK08/5J



Diffuser:
Polycarbonate



Construction:
Aluminum &
Stainless Steel



L&B Life Rating
L90 B10
54 000 hrs

Premium

Raw Lumen:
Effective Lumen:

240V:

Raw Efficacy:
Effective Efficacy:

L90 B10 @ 25°:
L80 B10 @ 35°:

2 Foot

2920 lm	3280 lm
2540 lm	2830 lm

18W	21W
------------	------------

161 lm/w	155 lm/w
140 lm/w	134 lm/w

>54 000 Hrs
>50 000 Hrs

4 Foot

5840 lm	7528 lm
5052 lm	6276 lm

36W	45W
------------	------------

165 lm/w	168 lm/w
143 lm/w	140 lm/w

>54 000 Hrs
>50 000 Hrs

5 Foot

7300 lm	8200 lm
6230 lm	7010 lm

44W	50W*
------------	-------------

169 lm/w	166 lm/w
144 lm/w	142 lm/w

>54 000 Hrs
>50 000 Hrs

Standard

Raw Lumen:
Effective Lumen:

240V:

Raw Efficacy:
Effective Efficacy:

L90 B10 @ 25°:
L80 B10 @ 35°:

5496 lm	6338 lm
5000 lm	5572 lm

36W	41W
------------	------------

155 lm/w	156 lm/w
141 lm/w	137 lm/w

>54 000 Hrs
>50 000 Hrs

6870 lm	7923 lm
6345 lm	7070 lm

44W	51W
------------	------------

156 lm/w	157 lm/w
144 lm/w	140 lm/w

>54 000 Hrs
>50 000 Hrs

Fitting Length:

620mm

1250mm

1540mm

Installation

Easy to install,
Saving you time & money

The Dustproof can either be installed as pendant or surface mounted.

Suspension Mounting

Spring Quick snap-on triangular attachment, no tools required.

Surface - Simple, quick surface installation (installation instructions provided in box)

*The 50W is only available as a 30° fitting

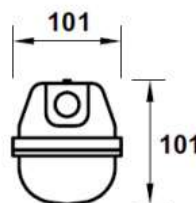

Dimensions

L	D
660	390
1277	800
1573	1100

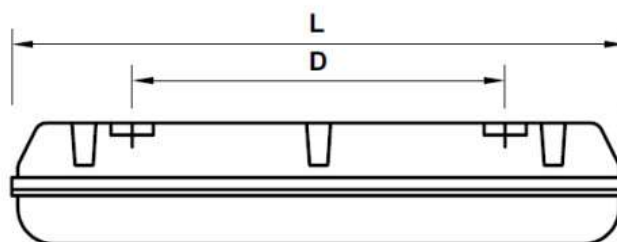

Disclaimer:

While every effort is made to ensure the accuracy of technical details at the time of publication, we reserve the right to modify or upgrade any product or component specifications without prior notice. Our products undergo continuous improvements in technology, energy efficiency, safety, and cost-effectiveness to meet evolving industry standards and supplier updates. All upgrades are made to enhance product quality, and as such, no claims or complaints will be entertained regarding specification changes.

We are ISO 9001:2015 compliant, and our assembly line adheres to IEC 60958 guidelines. Our products are covered by a Product Liability Policy, and our LED products come with a 5-year warranty (T&Cs apply—please contact Head Office for details).



Distribution Options

Precision Lighting for Zone 21/22 Environments.

LED Dustproofs are designed to protect your LEDs while providing reliable, efficient lighting for specific areas, surfaces, or objects. These versatile luminaires are ideal for both indoor and outdoor applications, offering more than just widespread illumination—they deliver targeted, consistent light where it's needed most.

Perfect for **passages, walkways, and car parks**, they create a well-lit yet visually comfortable environment. Built with premium materials and components sourced from leading European manufacturers, our **LED Dustproofs** ensure durability, performance, and long-term reliability.

Dustproof Distribution

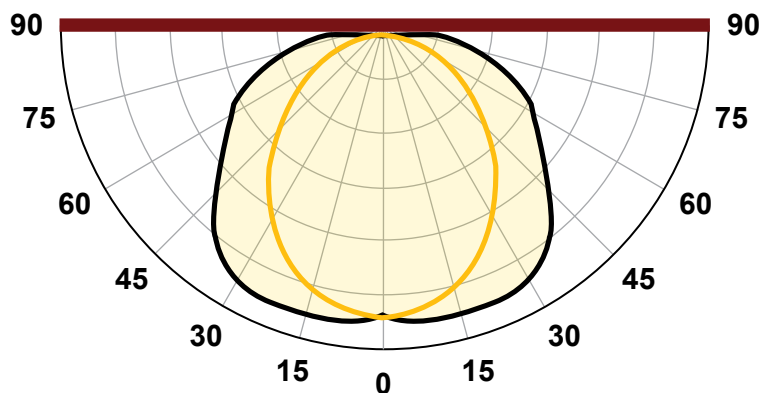

A Closer Look

Engineered to the highest standards.

Shroud

A durable aluminium shroud designed to protect the luminaire from impact, tampering, and vandalism. Its robust, corrosion-resistant construction enhances fixture longevity and reliability, making it ideal for demanding environments where additional protection is required.

Diffuser

Polycarbonate diffuser offers great IK08 impact protection and efficient distribution of light. The continuous silicone gasket allows a water-resistant (IP66) assembly.

LEDs

Source from the best component manufacturers in Europe to ensure maximum lifespan, quality and light spectrums.

Finishings

All fasteners are Stainless Steel 304 for longevity.

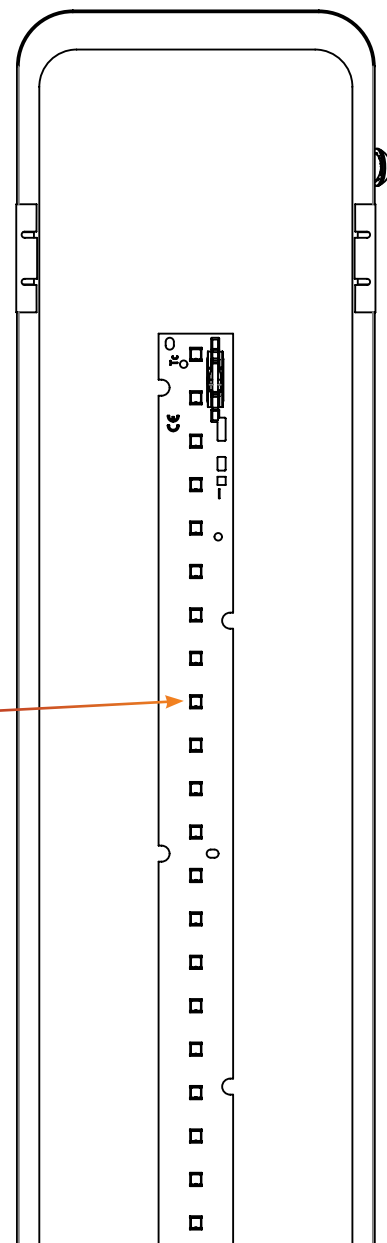
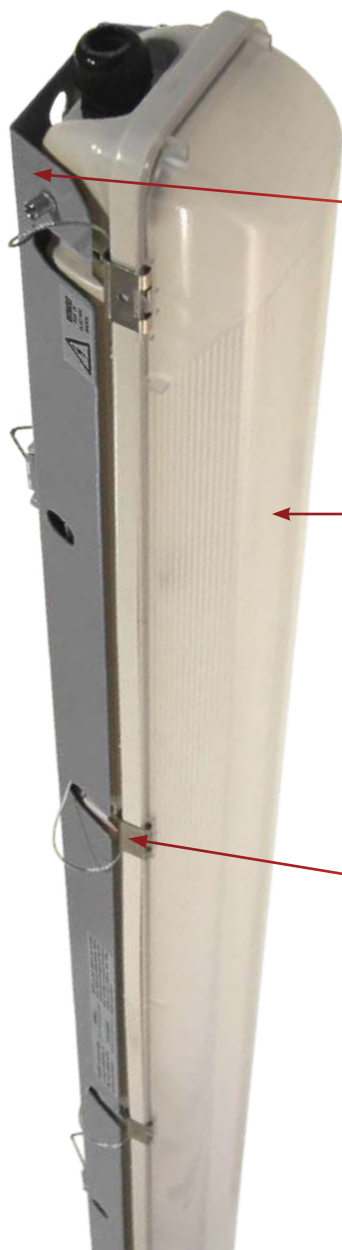

VANDAL-RESISTANT SHROUD





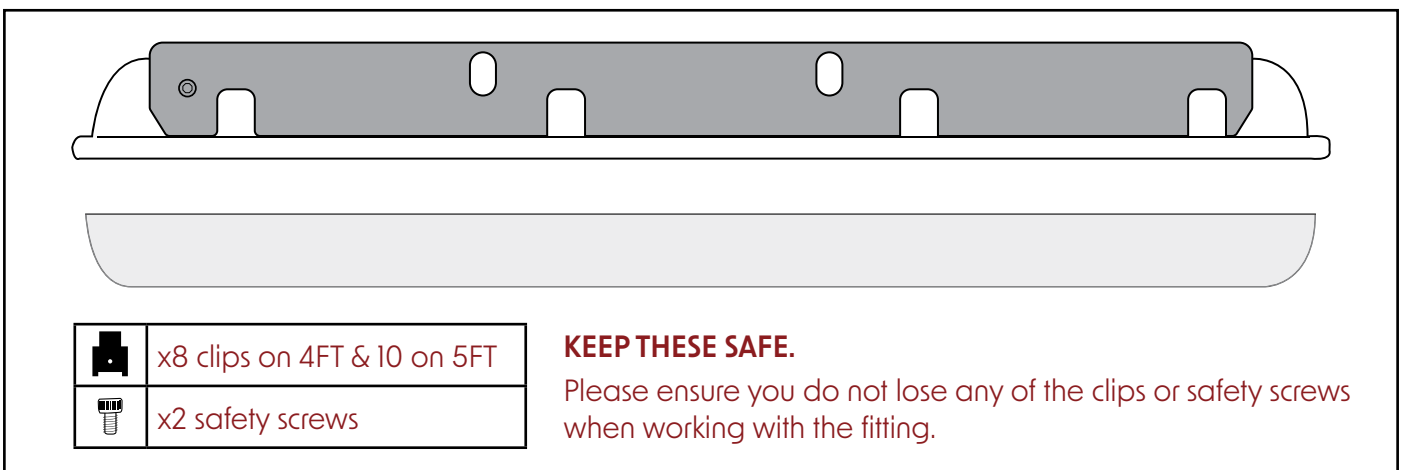
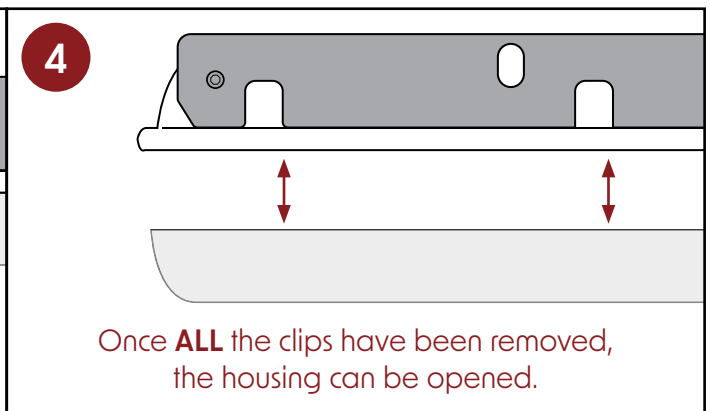
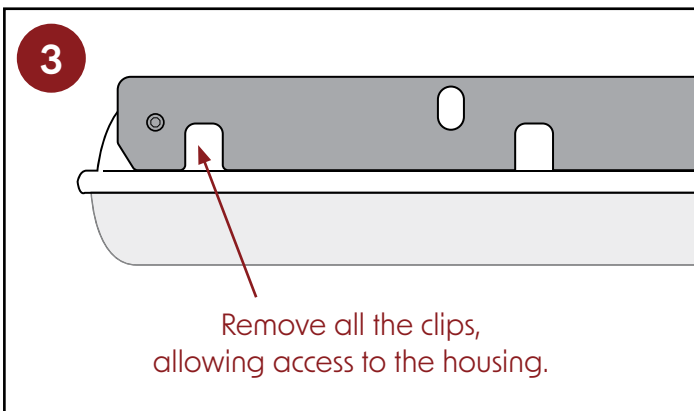
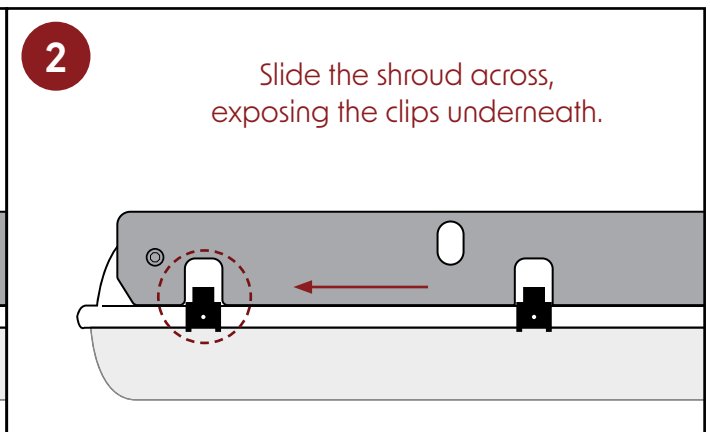
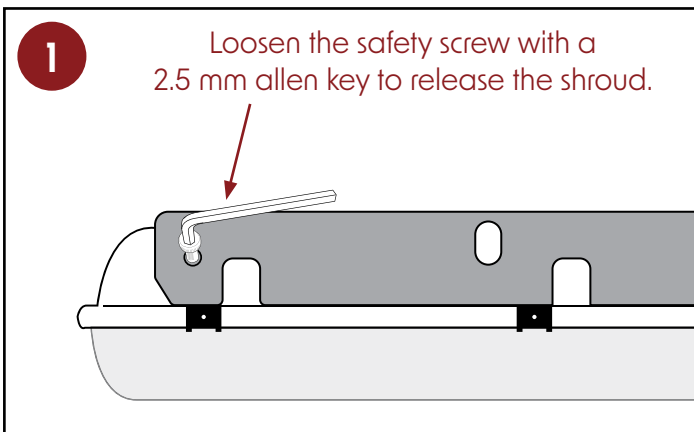
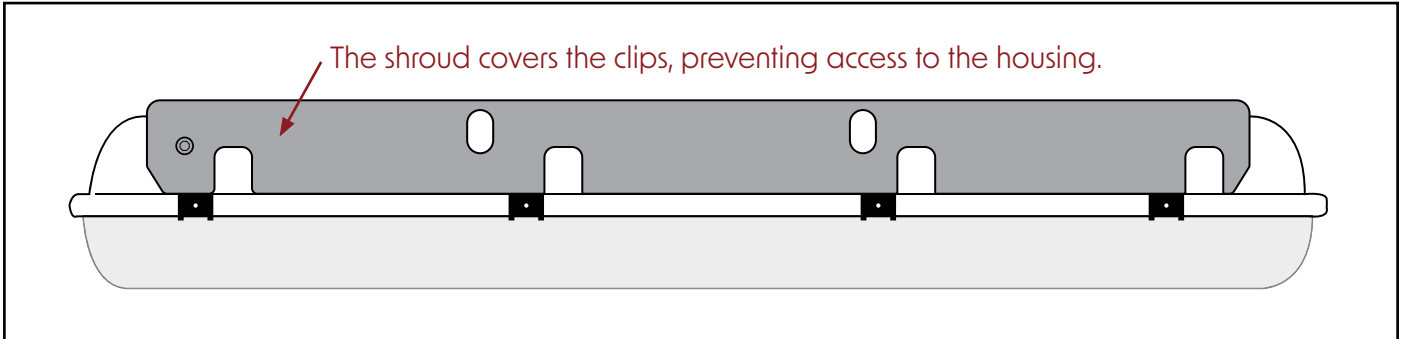









Vandal-resistant shroud is designed to keep your light fitting securely fastened in high-risk environments. This heavy-duty shroud help prevent tampering and unauthorized access.

Each fitting has regular clips and a shroud.





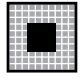



Features

Standard across the Dustproof range.

-  SABS Approved
-  Indoor/Outdoor
-  Polycarbonate Body.
-  Serviceable: All units are serviceable and all parts replaceable.
-  5000K Standard, 3000K, 4000K, 6500K on request.
-  Colour rendition index 80+
-  LED Life rating: L90 B10, 54 000 hrs
-  Earth connection and CLASS I insulation fixture.
-  Optic impact rating IK08/5J.
-  Voltage surge protection up to 4kv.
-  All screws & mini shackles in stainless steel 316.
-  Suspended by chain or steel cable. (not included)
-  Surface mount.
-  Top Bin Chips <3 MacAdams
-  Tamperproof

Extras

Optional extras.

-  Casambi bluetooth technology.

-  All units can be fitted with Dali or bi-level driver.
-  Voltage surge protection. Up to 10kv.
-  IES files available.
-  Emergency battery backup
-  VOLTpro
Effective Lumen Output After Warm-up
We adhere to industry best practices in providing accurate Effective Performance Data (Lumens, Watts, and L&B) that account for driver and LED thermal losses during the warm-up period.
To ensure precise measurements, we conduct Energy and Photometric Testing only after the LED within the fitting has been powered on long enough to reach a stable and constant lumen output—achieving thermal equilibrium at an ambient temperature (Ta) of 35°C.
Unfortunately, some suppliers misrepresent efficacy by inflating lumen values 10–20% above the true effective output. This is often done by using raw LED photometric data, which:
- Excludes driver losses (typically 2–5%)
- Ignores thermal adjustment losses, which can take 20–240 minutes and account for 7–15% reduction in output
Given these factors, the actual Effective Lumen Output is often lower than raw values suggest. In extreme cases, some suppliers report only raw LED values, completely disregarding real-world performance.
For transparency and accuracy, we ensure our data reflects true effective lumens, providing reliable performance metrics you can trust.



5 year warranty:
Please visit
www.energywise.co.za

Designed and
Manufactured by

energywise

Better Light
Through Research.

sales@energywise.co.za | www.energywise.co.za

T: +27 31 764 2345 / +27 87 941 0012

Physical address: Unit 5 Edstan Business Park, 2 Ibhubesi Road, Riverhorse Valley, Durban, South Africa, 4017





Postal address: PO Box 1166, Kloof, South Africa, 3640

Energywise lighting options

Energywise specialises in LED luminaries for industrial, EX, commercial and horticultural applications.

INDUSTRIAL

						
Bay XP Factories, Warehouses, Cold rooms etc.	Bay XL Factories, Warehouses, Supply rooms etc.	Bay XE Factories, Warehouses, Supply rooms etc.	DUSTPROOF Warehouses, Car parks, Corridors.	VANDAL-RESISTANT DUSTPROOF Car parks, Corridors, Mills.	PUREBox Panel Medical & laboratory, Clean rooms etc.	Torch Bulkhead Heavy industrial areas.
Standard Height: 6-25m IP: 65 Temp: 40/65°C	Standard Height: 3-20m IP: 40 Temp: 30°C	Standard Height: 6-25m IP: 20 Temp: 30°C	Standard Height: 2.5-8m IP: 66 Temp: 35°C	Standard Height: 2.5-8m IP: 66 Temp: 35°C	Standard Height: 3-5m IP: 54 Temp: 35°C	Standard Height: 6-25m IP: 65 Temp: 30°C

				
Pod IP65 Tamperproof and nearly unbreakable.	Bay XF Get the job done, Glare-Free.	Plate XP Swiss army knife of lighting.	TOBLO bay Factories, Warehouses, Supply rooms etc.	Bay XT Distribution centers, Warehouses etc.
Standard Height: 2-5m IP: 65 Temp: 35°C	Standard Height: 2-10m IP: 20 Temp: 30°C	Standard Height: 6-25m IP: 65 Temp: 35°C	Standard Height: 6-25m IP: 40 Temp: 40/30°C	Standard Height: 3-20m IP: 40 Temp: 35°C





RETROFIT

	
Retrofit 44 Converting old HID tech to LED	Retrofit 22 Converting old HID bulkhead to LED
Standard IP: 00 Temp: 30°C	Standard IP: 00 Temp: 35°C



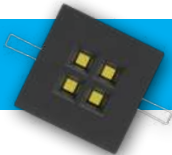
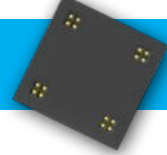
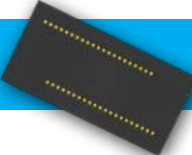

RETAIL & COMMERCIAL

						
LEDrail 1000 Shops, Production facilities, parking	LEDrail 2000 Shops, Sheds, Underground parking	LEDrail 4000 Retail, board rooms, department stores.	LEDrail 8000 Retail, board rooms, department stores.	LEDrail 4-100 All retail outlets, showrooms, offices etc	LEDrail 4LCO Shops, Production facilities, showrooms etc	Linear 4-300 Glare free precision lighting
Standard Height: 2.5-10m IP: 40 Temp: 30°C	Standard Height: 2.5-10m IP: 40 Temp: 30°C	Standard Height: 2.5-6m IP: 40 Temp: 35°C	Standard Height: 2.5-6m IP: 40 Temp: 35°C	Standard Height: 2.5-10m IP: 40 Temp: 35°C	Standard Height: 2.5-10m IP: 40 Temp: 35°C	Standard Height: 2.5-10m IP: 40 Temp: 35°C

EX

						
Downlighter Offices, retail and hospitality settings.	Panel 595x595 Offices, healthcare, educational facilities.	Panel 1195x595 Offices, commercial, educational settings.	EX Bay XP Factories, Warehouses, Mills, Marine etc.	EX DUSTPROOF PREMIUM Warehouses, Car parks, Mills.	EX DUSTPROOF Warehouses, Car parks, Corridors, Mills.	EX Pod Factories, Mines, Marine etc.
Standard IP: 40 Temp: 30°C	Standard IP: 40 Temp: 30°C	Standard IP: 40 Temp: 30°C	Standard Height: 6-25m IP: 65 Temp: 40°C	Standard Height: 2.5-8m IP: 65 Temp: 35°C	Standard Height: 2.5-8m IP: 65 Temp: 35°C	Standard Height: 2-5m IP: 68 Temp: 40°C

EARTH

			
EX Torch Heavy industrial areas.	EARTHbay Horticulture, Open areas etc	EARTHplate Horticulture, Rack/ Under shelf etc	EARTHpod Horticulture, Propagation, Racks etc.
Standard IP: 65 Temp: 40°C	Standard From canopy: 0.5-2m IP: 65 Temp: 35°C	Standard From canopy: 0.4-2m IP: 65 Temp: 35°C	Standard From canopy: 0.2-1m IP: 65 Temp: 35°C

Lights on. Job done.

energywise

Better light
through research.